

# ARCTIC AIR™

Evaporative Air Cooler



Distributed by



©2017 Ontel Products Corp.

Fairfield, NJ 07004

All Rights Reserved.

Made In China

AAIM51217-TVP

# ARCTIC AIR™

Evaporative Air Cooler



## Product Guide

# WHAT'S INCLUDED:

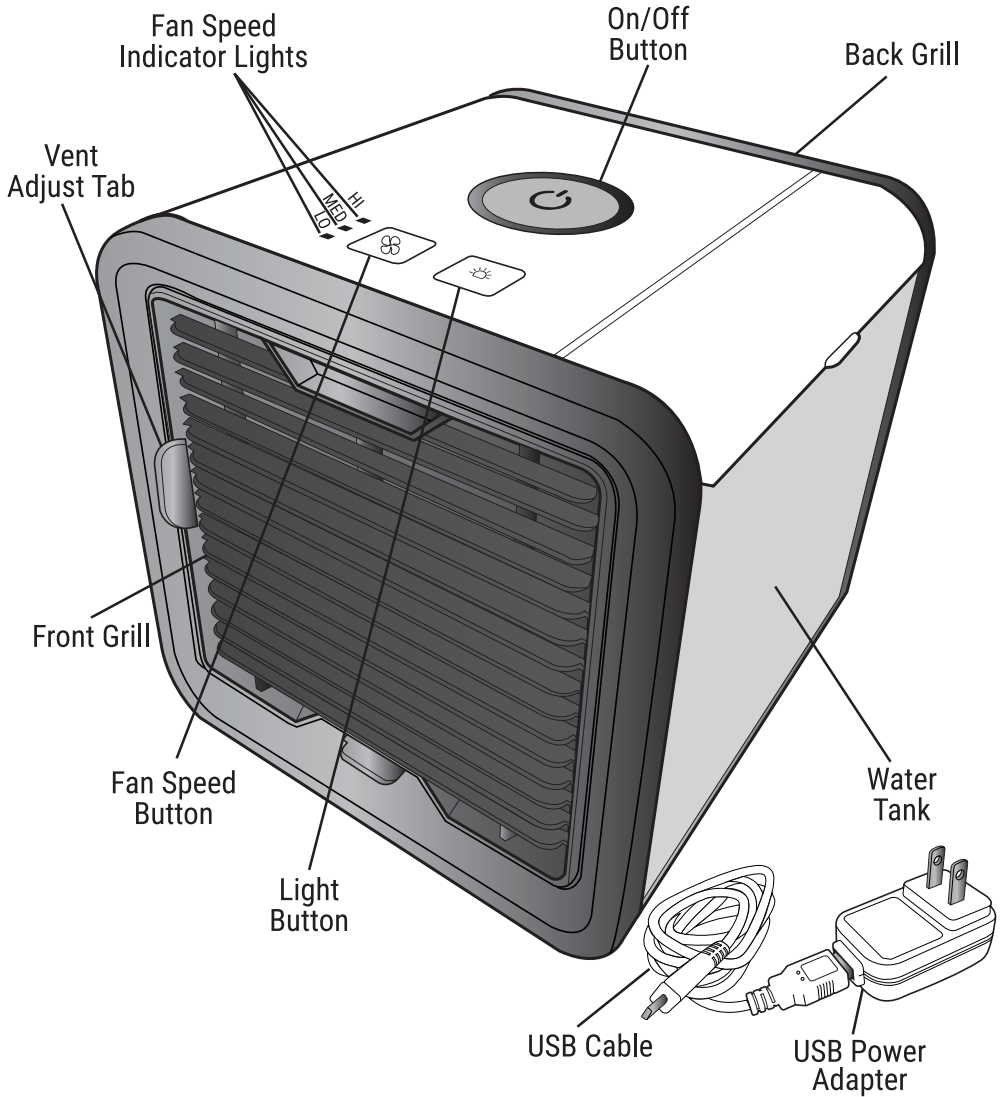

**READ ENTIRE MANUAL BEFORE USE**

**SAVE THESE INSTRUCTIONS**

## **WARNINGS (CONT.):**

- People with limited physical, visual or mental abilities or lacking proper experience and/or knowledge should never use the device without supervision of those responsible for their safety or those capable of assistance in using the device.
- The device can be switched off completely only when disconnected from the power supply.
- The manufacturer does not bear any responsibility for any damage from failure to comply with this product guide.
- A replaceable water filter is designed specifically for this product. If your cartridge has been broken or damaged, you can purchase a replacement.

## **NOTES:**

### **FOR HOUSEHOLD USE ONLY**

Model Number: 17013  
AC100~120V  
DC 5V , 1.5-2.0A

1217.0101



## MAINTENANCE:

We recommend cleaning the water tank and inside of the unit once weekly. Use only a non-abrasive cloth and mild dish soap when needed.

For best continued results, we recommend changing the filter every 6 months.

To purchase filters, visit [www.ArcticAirFilter.com](http://www.ArcticAirFilter.com), call 844-260-1487, or e-mail [arcticaircs@worldpackusa.com](mailto:arcticaircs@worldpackusa.com).

## CHANGING THE FILTER:



The Water Filter should be changed every 6 months, or when you feel Arctic Air™ is not functioning as it should be. The Water tank will light up AMBER until filter is reset. To reset the filter, hold the  and  button for 3 seconds until tank is not AMBER anymore.

To purchase a replacement filter visit [www.ArcticAirFilter.com](http://www.ArcticAirFilter.com), call 844-260-1487, or e-mail [arcticaircs@worldpackusa.com](mailto:arcticaircs@worldpackusa.com).

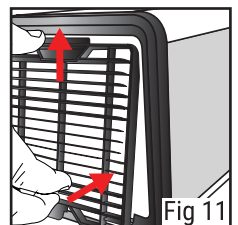
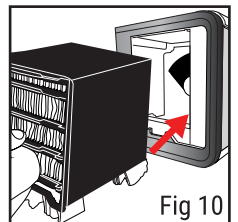
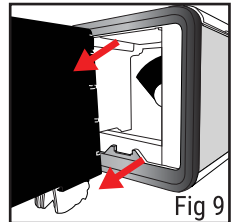
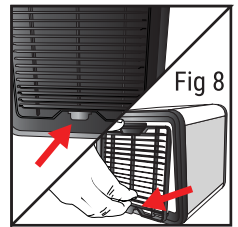

1. Unplug Arctic Air™ from the wall.
2. Gently press in release tab on bottom of front grill and pull grill down and away from unit. Place aside. (See Fig 8)
3. Grab onto filter and carefully slide out of unit completely. (See Fig 9)
4. Place new filter in Arctic Air™ as shown by markings on filter. (See Fig 10)
5. Insert top tab of front grill into slot, and press release tab back into place. (See Fig 11)



## USAGE:

1. Press Power button to power on Arctic Air™.  
(See Fig 4)
2. Set the Fan speed by pressing  button. You can choose from Low, Medium, and High Mode. The indicator lights next to the button show you which speed Arctic Air™ is currently running. (See Fig 5)
3. Choose your light color by pressing  button. You can choose between solid colors or a color-cycle mode. (See Fig 6)

*COLOR ORDER: Blue, Red, White, Teal, Purple, Yellow, Green, Color Cycle*

4. Choose your light brightness by pressing and holding the  button for 3 seconds – the tank will blink. Repeatedly press the  button to choose between High, Medium, and Low, then stop. The tank will blink after 3 seconds to confirm setting has been locked in.
5. Adjust air flow direction up or down by using Vent Adjust Tab on front grill (See Fig 7).
  - Down Position – Air flows up
  - Center Position – Air flows straight out
  - Up Position – Air flows down

6. When you're done, press the Power button again to turn off your Arctic Air™.

*NOTE: We recommend running Arctic Air™ on HIGH mode for at least 5 minutes before powering off to allow for drying.*

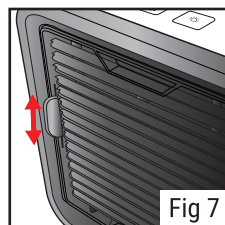
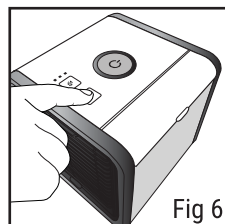
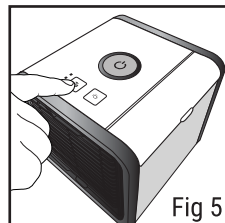
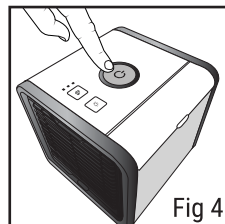

## LOW WATER:

When water level is low, water tank will blink 3 times every 60 seconds in AMBER color. When tank is filled again, light will function as normal again.

## TIPS:

- Place Arctic Air™ on a raised surface such as a table, desk or counter top. This is the best way to cool your personal area faster.
- Let filter absorb water for at least 3 minutes after filling tank and before use. Doing so will get you the coolest air quicker.
- Try to stay within a few feet of Arctic Air™. You'll feel the most benefit when sitting directly in front.
- Arctic Air™ will run for approximately 8 hours on a single fill on Low fan speed. Even if water tank is empty, filter is still damp and Arctic Air™ is still cooling.

## SETUP:

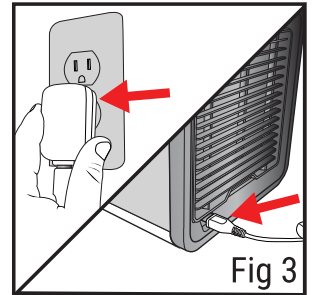
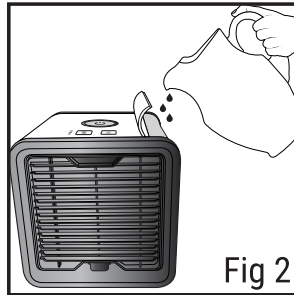
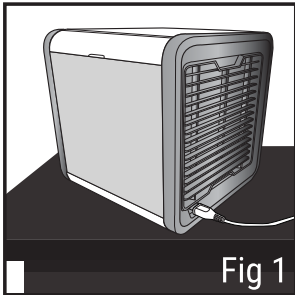

1. Place Arctic Air™ on a flat surface. (See Fig 1)
2. Open the water tank door and fill with water (See Fig 2). We recommend a pitcher or measuring cup.
3. Plug USB power adapter into an outlet. Then, insert larger USB end of cable into the adapter and the smaller end into the power port on the back of Arctic Air™. (See Fig 3)

*NOTE: You can plug the larger USB end into a computer to power Arctic Air™ as well.*

# WARNINGS:

- Do not carry Arctic Air™ when filled with water. Some water may remain in unit even if tank is empty.
- Use only clean water. If needed, use distilled water.
- Please read and follow regular maintenance as recommended in “Maintenance” section of this guide.
- Arctic Air™ works best in non-polluted areas. Large dust/dirt particles may reduce lifetime of unit.
- We recommend use only in dry locations. If using in a moist area or environment, take care not to get water on external areas of the product.
- If a leak or spill occurs on the surface of device, unplug Arctic Air™ and let it dry for 24 hours. Then, use as normal.
- Do not place in direct sunlight for extended periods of time.
- Before not using Arctic Air™ for extended periods of time, empty the water tank, turn unit on, and set to highest fan speed for at least 4 hours. This will dry out then filter and inside of your unit.
- Only use the original power adapter and cord supplied in package.
- Do not touch the power supply or power cord with wet hands.
- Unplug Arctic Air™ when cleaning, removing/replacing filter, or moving the device.
- For best results, place Arctic Air™ on a higher surface like a table or countertop.
- Do not place Arctic Air™ near a heater or any electrical equipment.
- Do not place the device in passageways or high traffic areas where there is a possibility of tripping or knocking it over.
- Do not allow any foreign objects inside Arctic Air™.
- Do not place items on top Arctic Air™.
- Do not block the front and back grills of the device.
- Do not turn the device upside down.
- Do not submerge the Arctic Air™ under water or other liquids.
- Do not place Arctic Air™ near open flames or fire sources.